

- AVAILABLE OPTIONS (NOT SHOWN):**
- \*COVERS (STANDARD OR VAPOR TIGHT)
  - \*LEVEL SWITCHES
  - \*TRANSFER PUMP PACKAGE:
  - INFLUENT
  - OIL
  - EFFLUENT
  - \*CONTROL PANEL

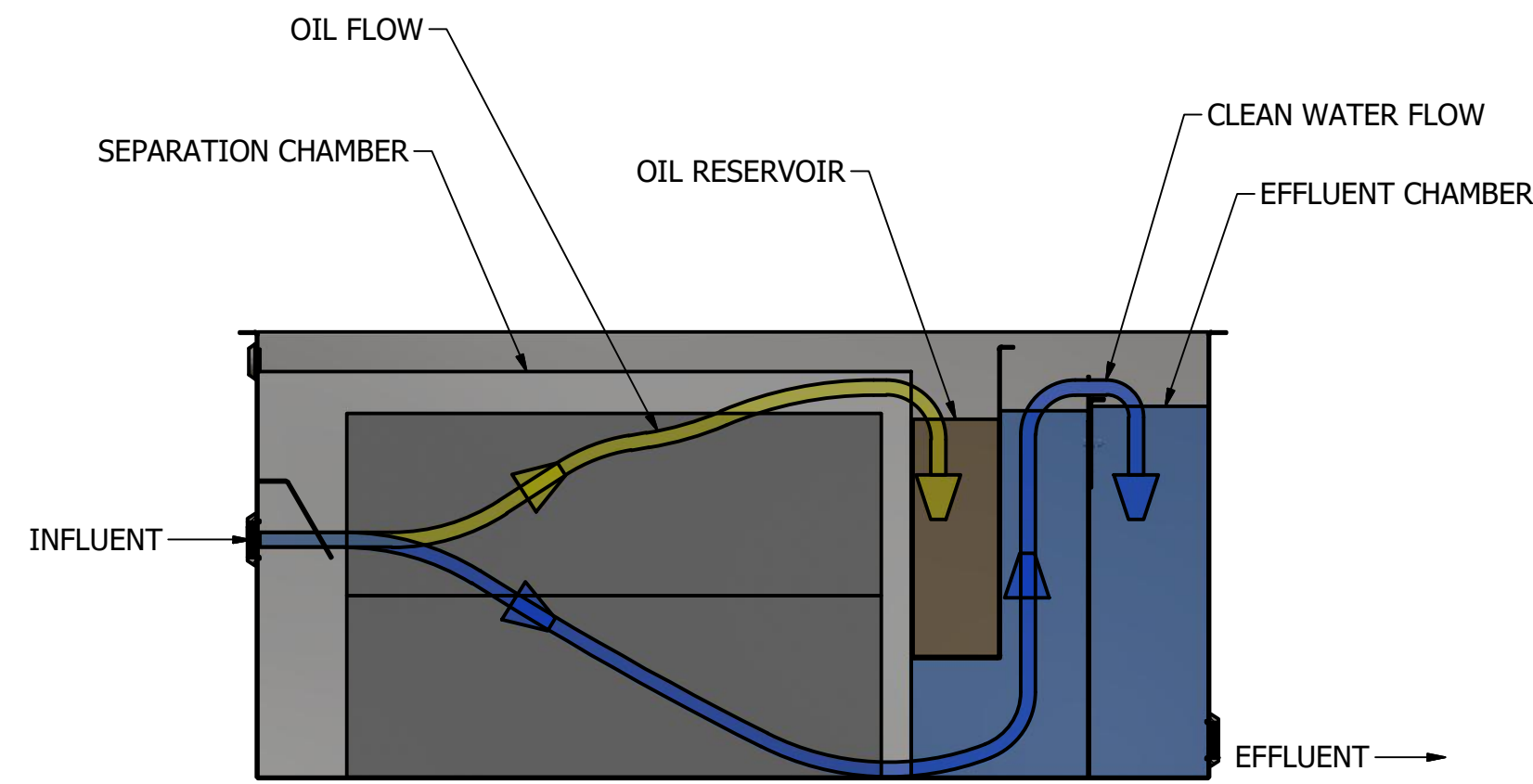

SECTION A-A  
SCALE 1 / 12

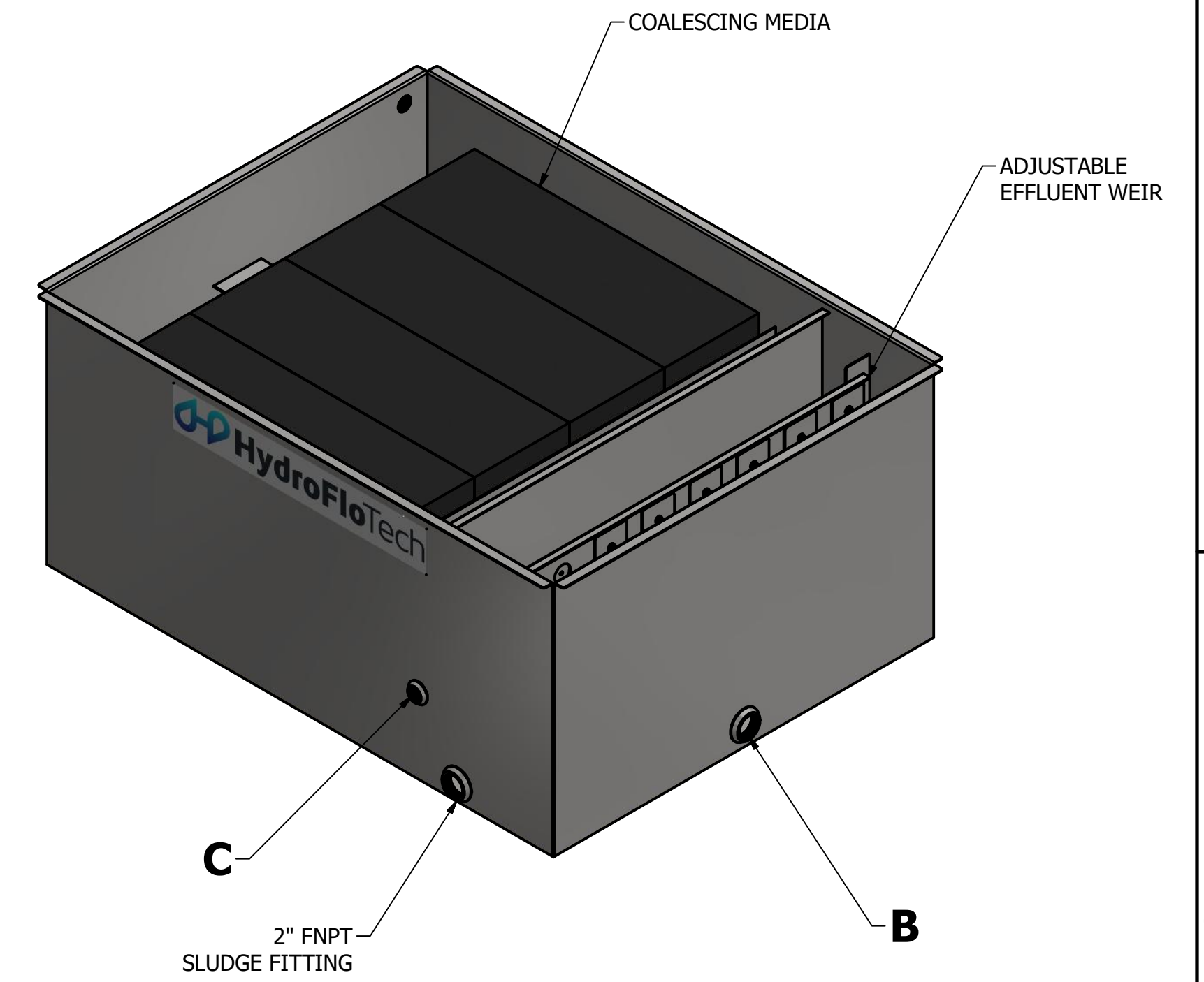
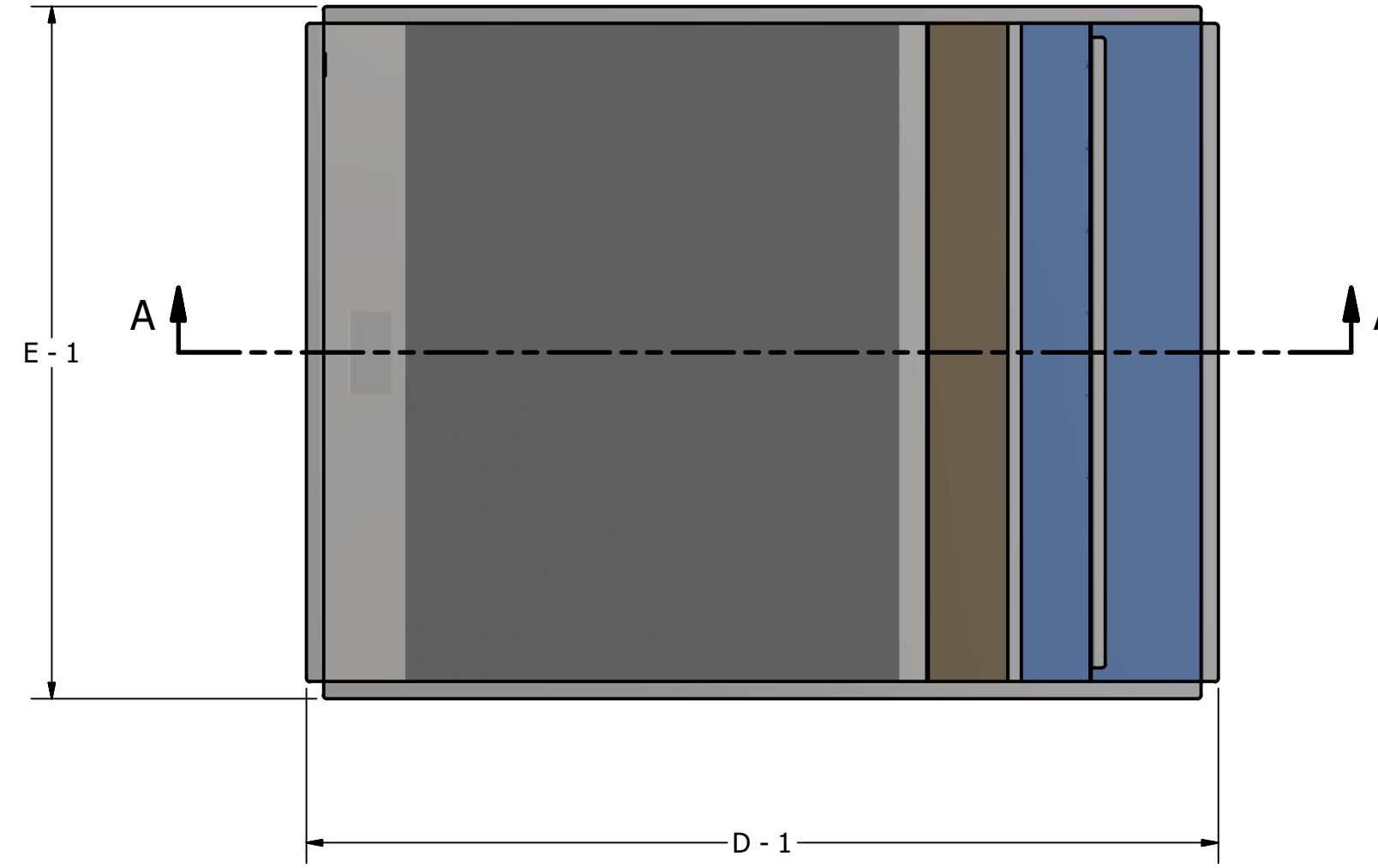
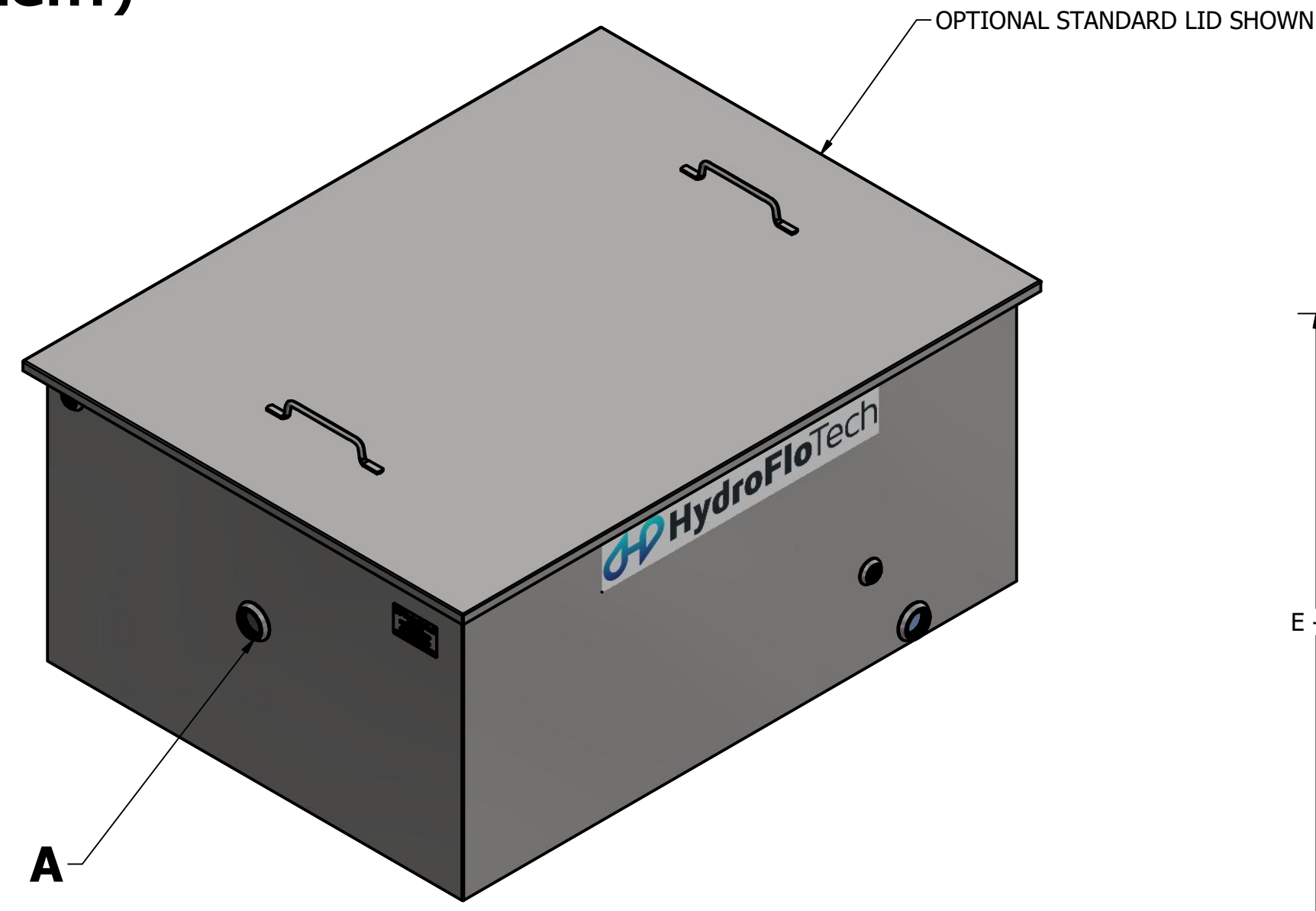
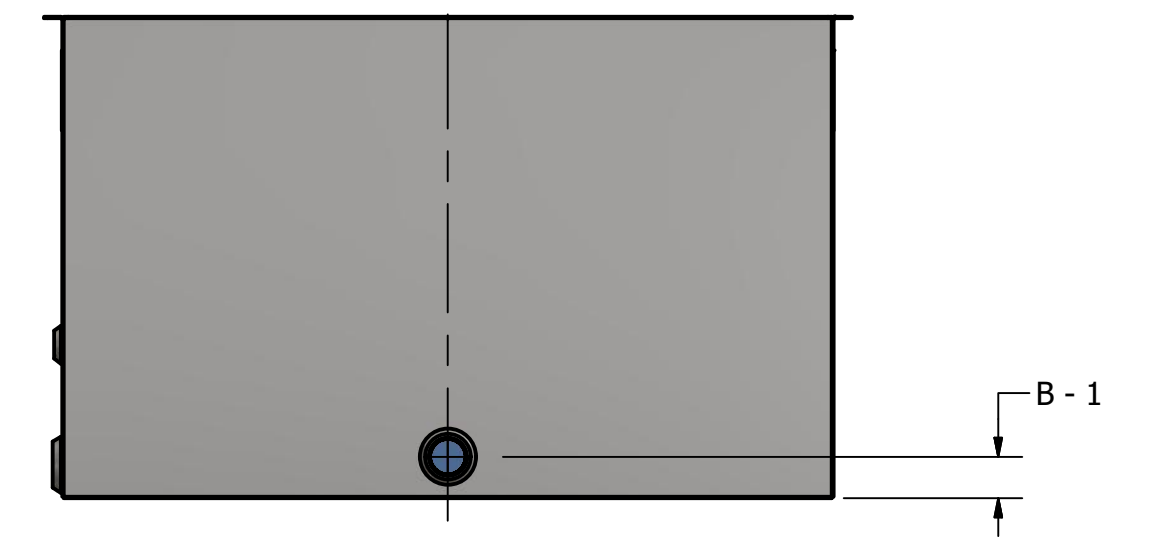
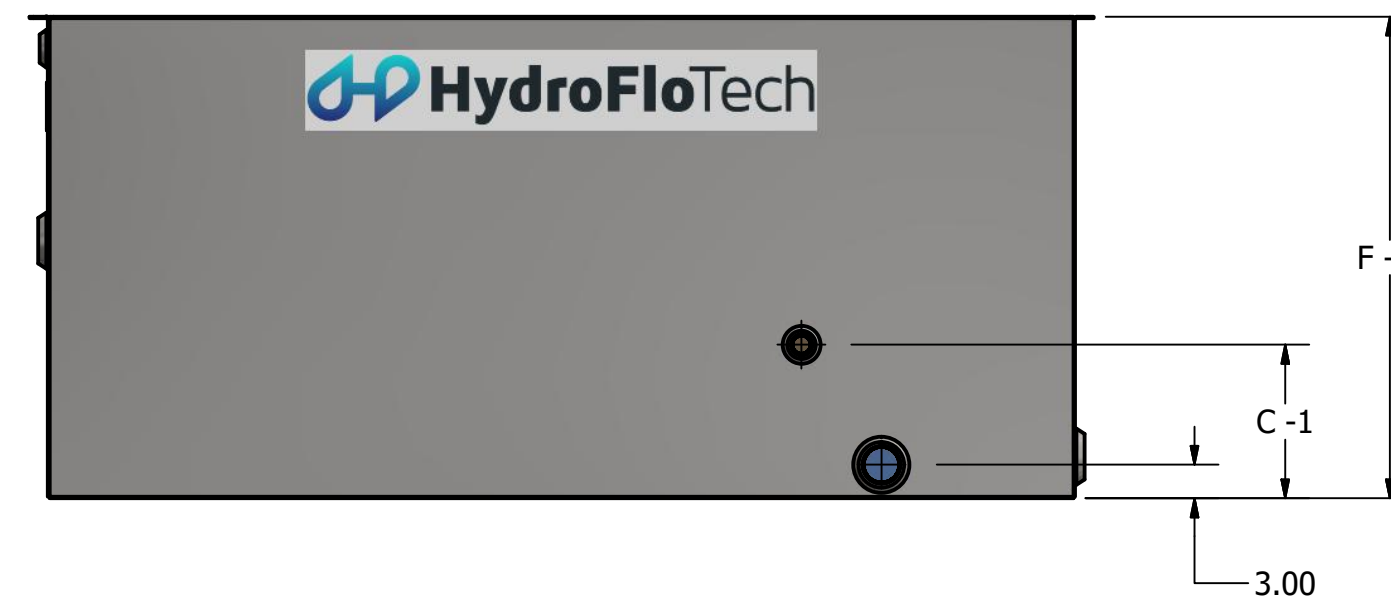
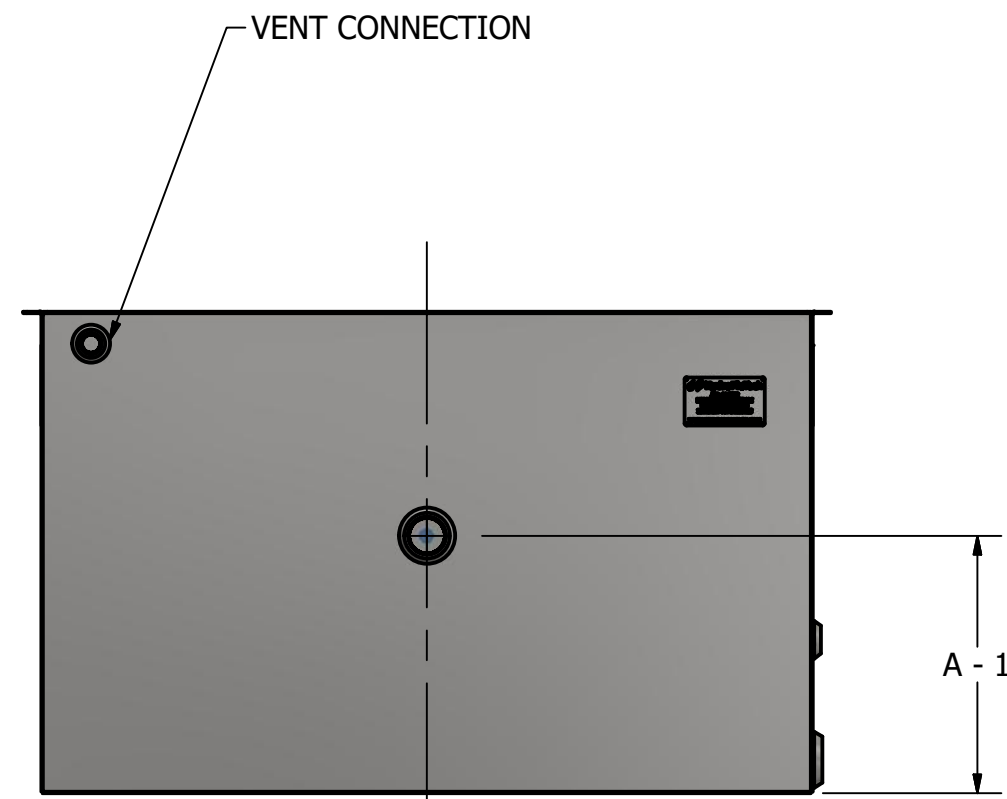

MODEL#	INFLUENT FITTING (A)	INFLUENT ELEVATION (A - 1)	EFFLUENT FITTING (B)	EFFLUENT ELEVATION (B - 1)	OIL OUTLET FITTING (C)	OIL OUTLET ELEVATION (C - 1)	UNIT LENGTH (D - 1)	UNIT WIDTH (E - 1)	UNIT HEIGHT (F - 1)	OIL CAPACITY (GALLONS)	EFFLUENT CAPACITY (GALLONS)	OPERATING WEIGHT (POUNDS)
ES-001	2"	0' - 9"	2"	0' - 3"	1"	0' - 6"	3' - 7"	1' - 3"	1' - 7"	2	5	337
ES-002	2"	0' - 9"	2"	0' - 3"	1"	0' - 6"	3' - 7"	2' - 3"	1' - 7"	4	10	601
ES-004	2"	0' - 9"	2"	0' - 3"	1"	0' - 6"	4' - 7"	2' - 3"	1' - 7"	4	10	769
ES-008	2"	1' - 5"	2"	0' - 3"	1"	0' - 10"	4' - 9"	2' - 3"	2' - 7"	9	25	1,531
ES-012	3"	1' - 5"	3"	0' - 4"	1"	0' - 10"	4' - 9"	3' - 3"	2' - 7"	14	38	2,226
ES-016	3"	1' - 5"	3"	0' - 4"	1"	0' - 10"	4' - 9"	4' - 3"	2' - 7"	19	51	2,916
ES-020	3"	1' - 5"	3"	0' - 4"	1"	0' - 10"	4' - 9"	5' - 3"	2' - 7"	24	64	3,621
ES-024	3"	2' - 1"	3"	0' - 4"	1"	1' - 2"	4' - 11"	4' - 3"	3' - 7"	28	92	4,440
ES-030	4"	2' - 1"	4"	0' - 4"	1"	1' - 2"	4' - 11"	5' - 3"	3' - 7"	36	115	5,503
ES-036	4"	2' - 1"	4"	0' - 4"	1"	1' - 2"	5' - 11"	4' - 3"	3' - 7"	28	92	5,399

**HydroFloTech**  
 1875 BIG TIMBER ROAD  
 ELGIN, IL 60123  
 (630) 762-0380  
 www.hydroflotech.com

DRAWN T. SUMMERS	6/4/2020	ISSUED FOR INFORMATION ONLY	
CHECKED		TITLE	
QA		HydroFloTech, OIL WATER SEPARATOR, ECONOSEP, ES-XXX, 304 STAINLESS STEEL	
MFG		SIZE D	DWG NO ES-TABULATED
APPROVED		SCALE 1 / 12	REV 0
		SHEET 1 OF 1	