

- AVAILABLE OPTIONS (NOT SHOWN):**
- *COVERS (STANDARD OR VAPOR TIGHT)
 - *LEVEL SWITCHES
 - *TRANSFER PUMP PACKAGE:
 - INFLUENT**
 - OIL**
 - EFFLUENT**
 - SLUDGE**
 - *CONTROL PANEL

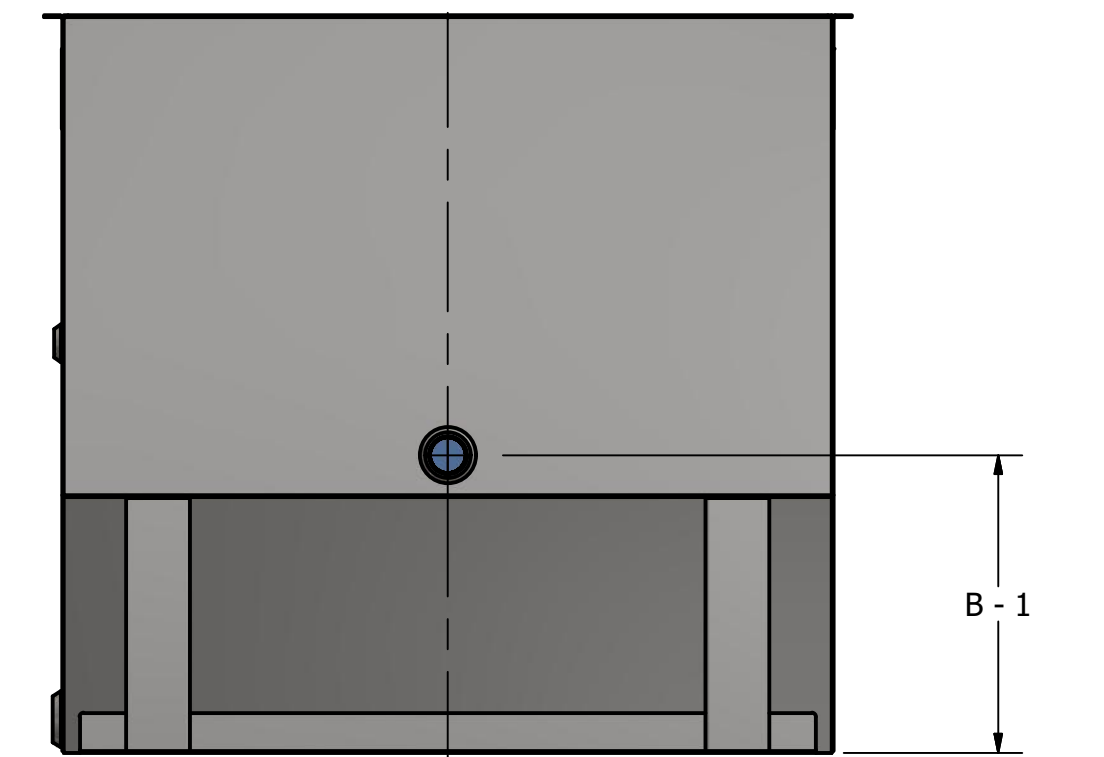
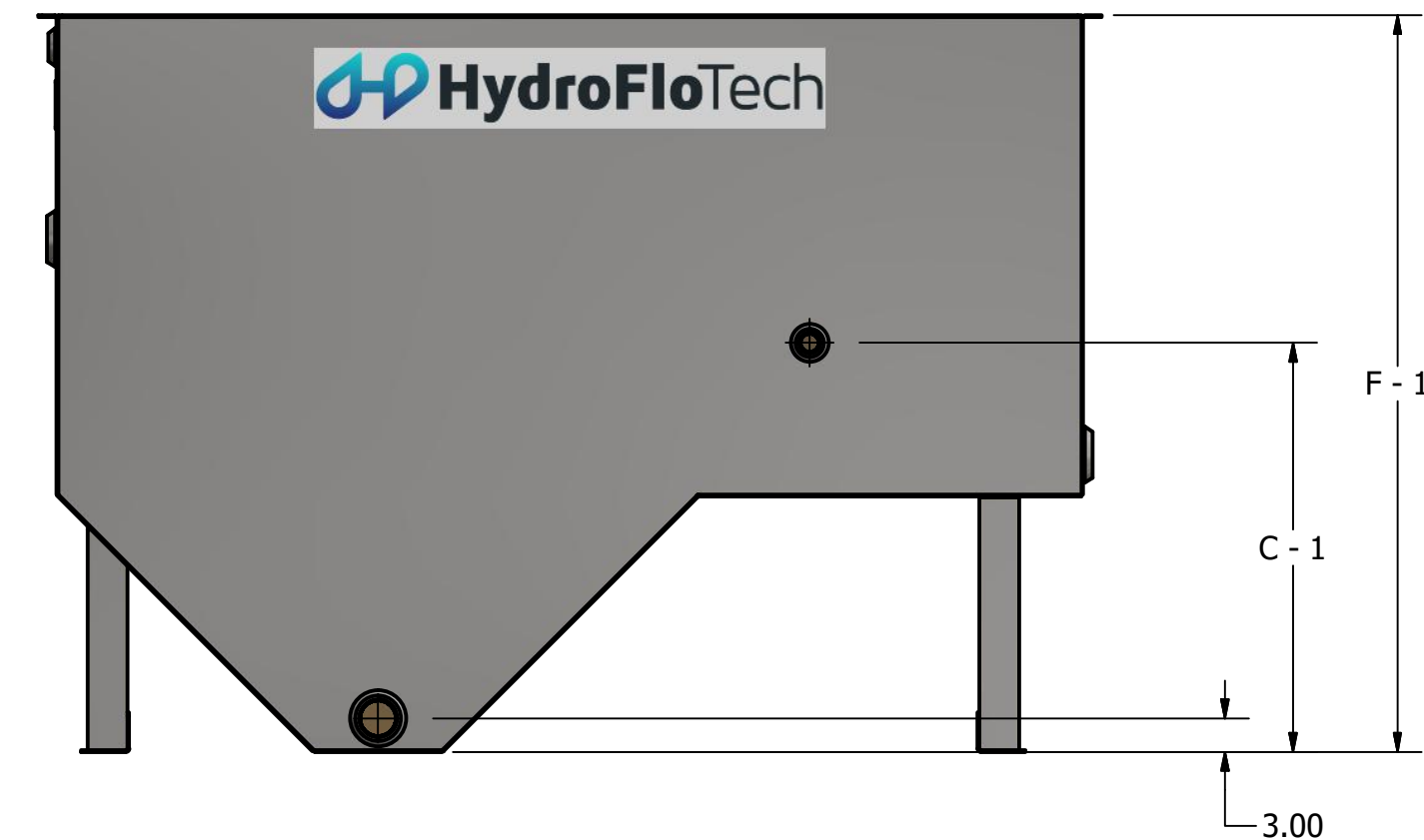
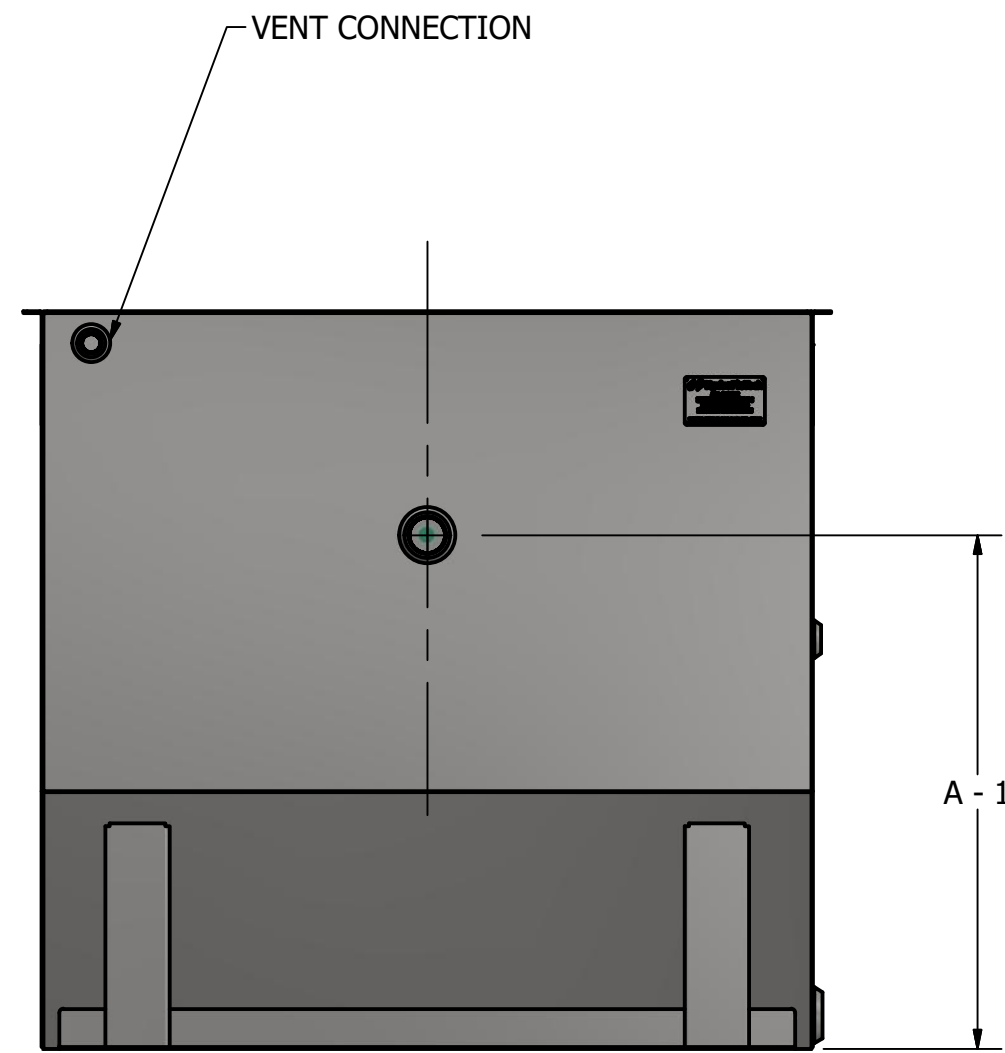
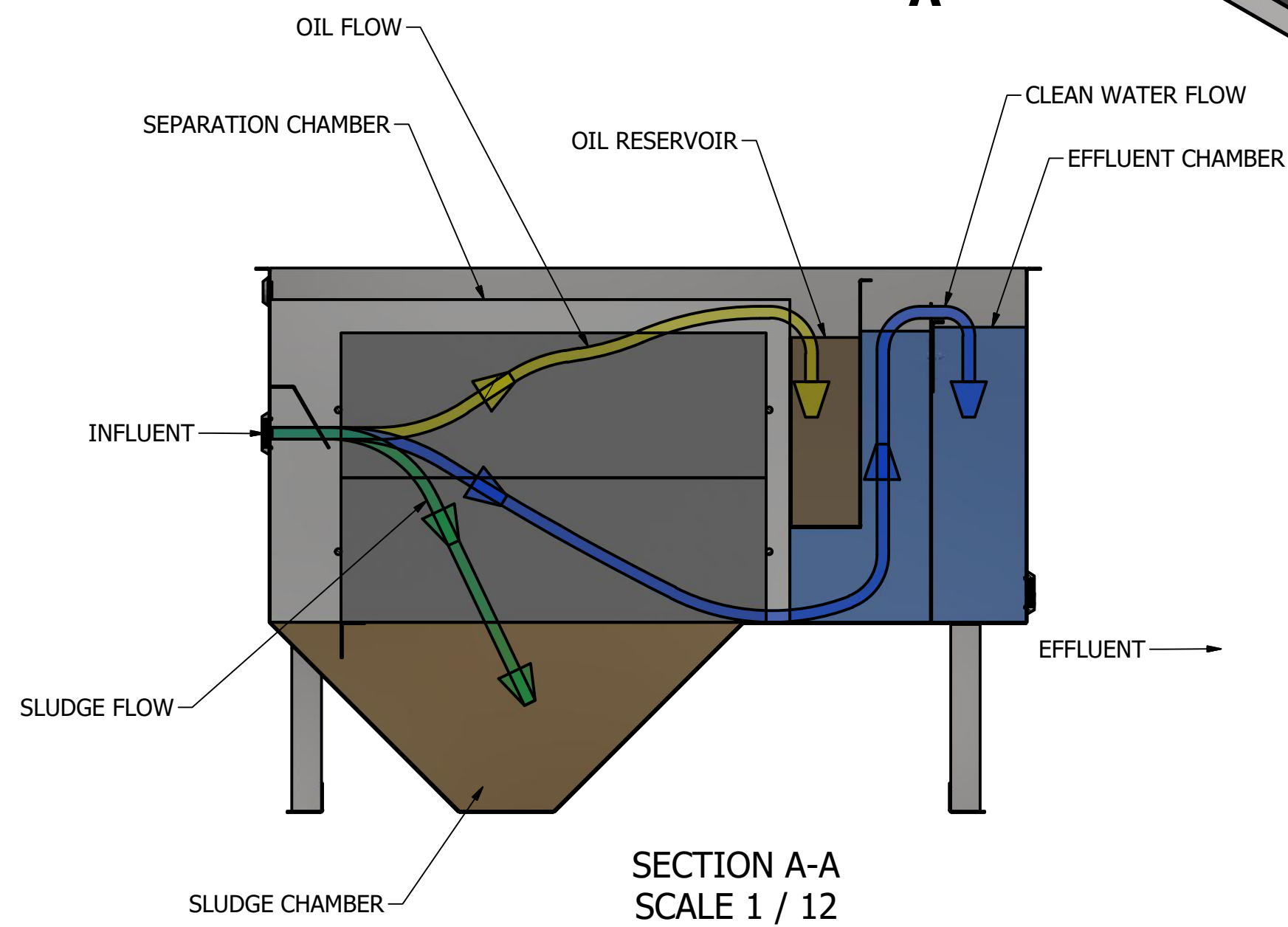
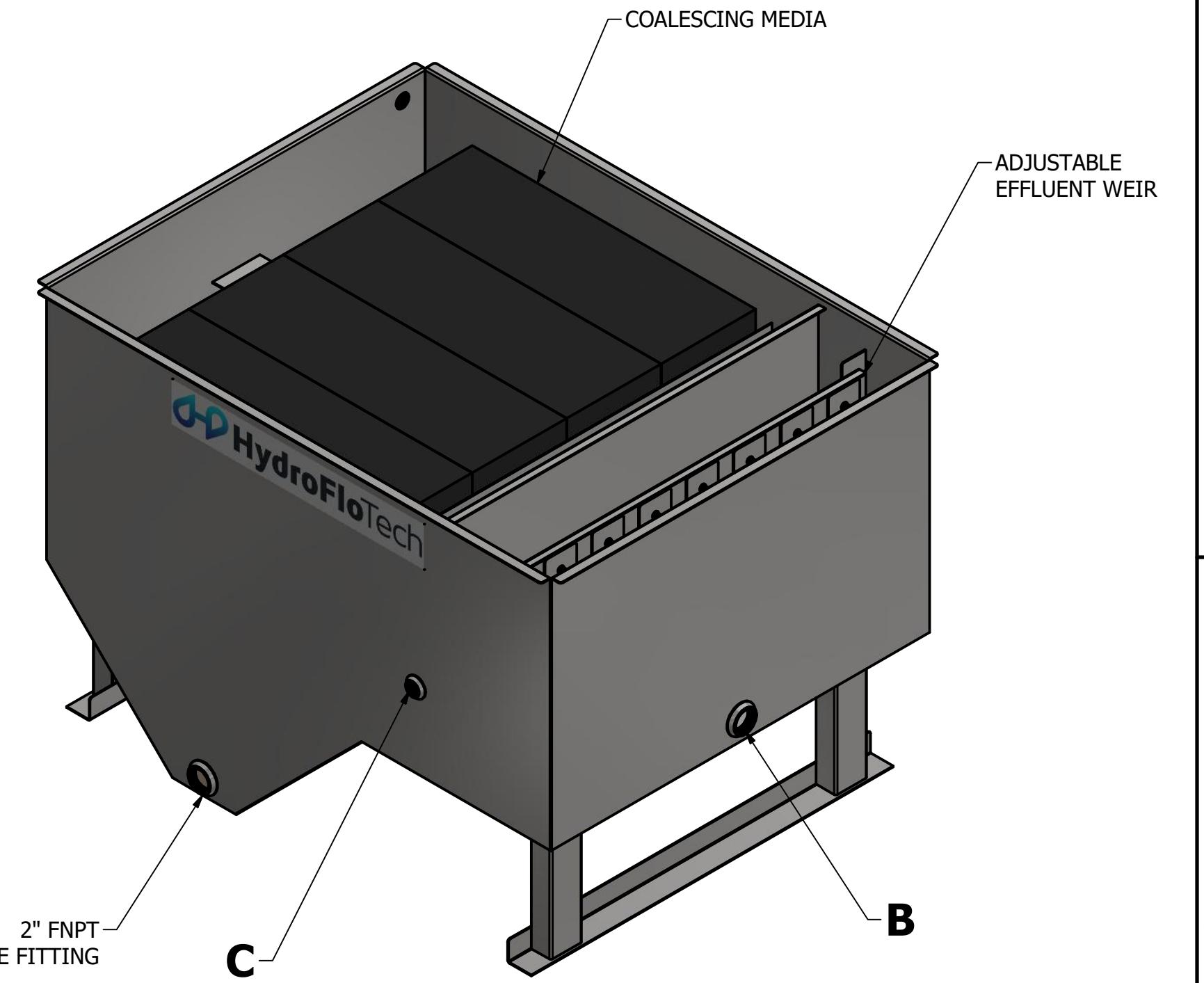
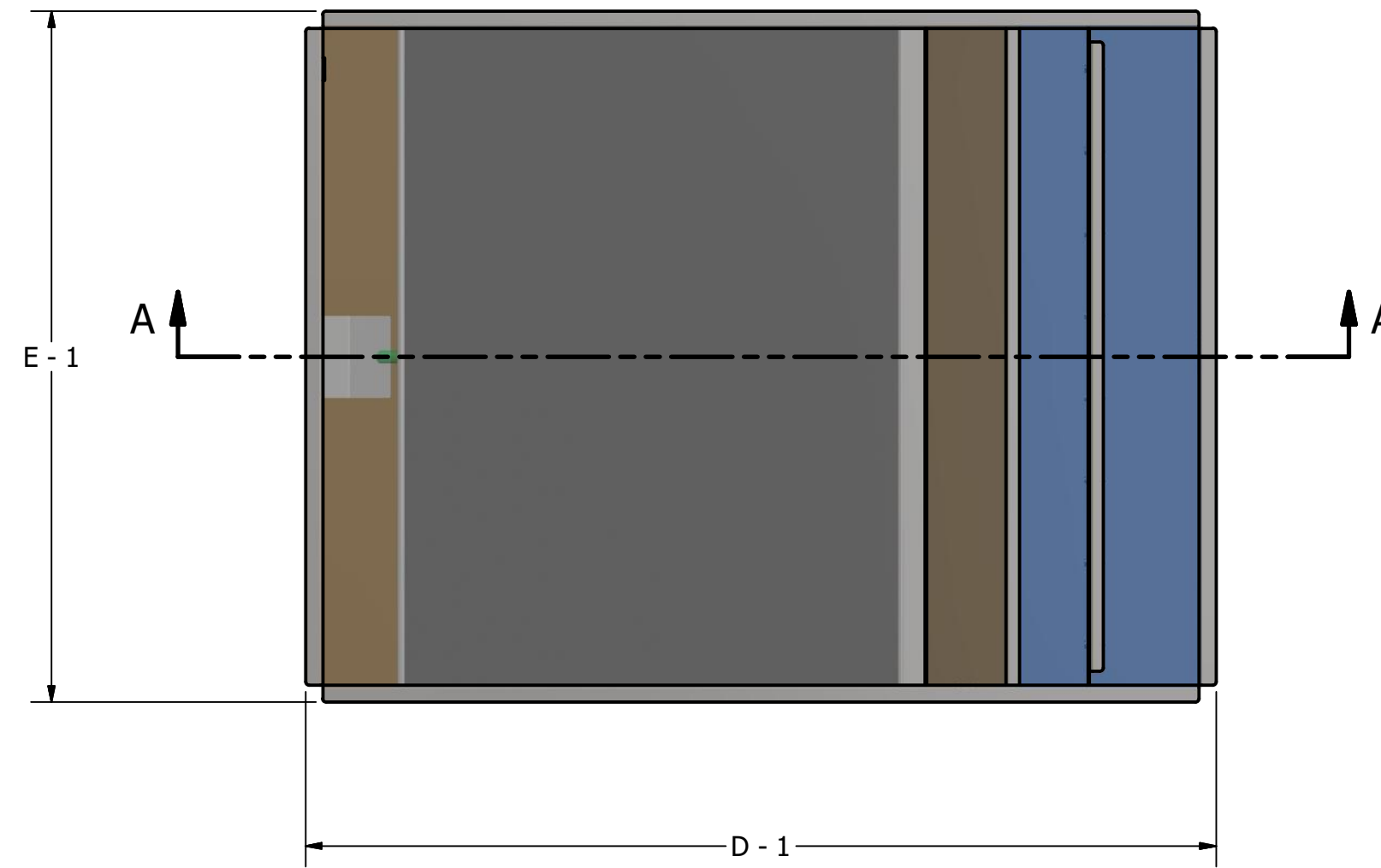
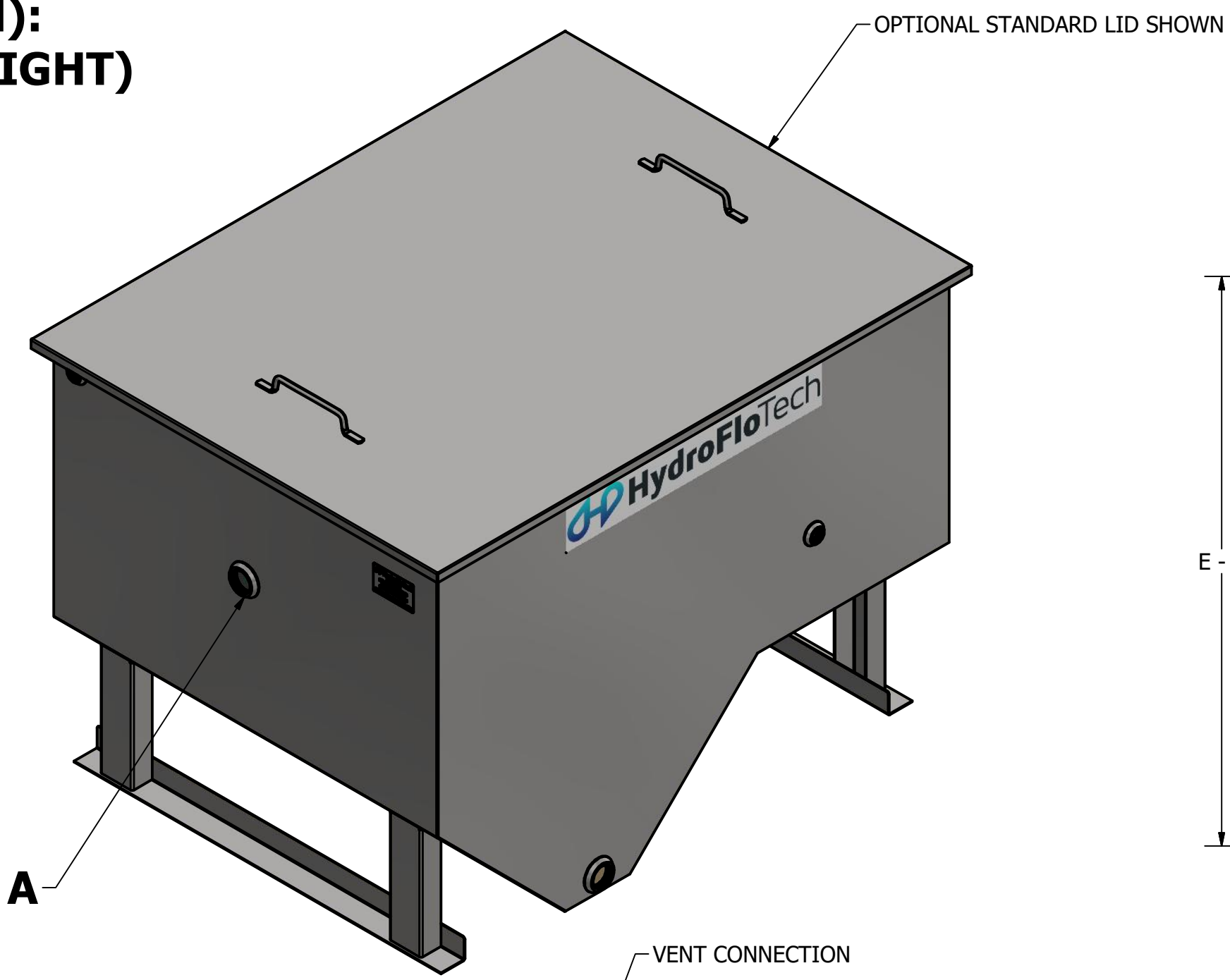

MODEL#	INFLUENT FITTING (A)	INFLUENT ELEVATION (A-1)	EFFLUENT FITTING (B)	EFFLUENT ELEVATION (B-1)	OIL OUTLET FITTING (C)	OIL OUTLET ELEVATION (C-1)	UNIT LENGTH (D-1)	UNIT WIDTH (E-1)	UNIT HEIGHT (F-1)	OIL CAPACITY (GALLONS)	SLUDGE CAPACITY (GALLONS)	EFFLUENT CAPACITY (GALLONS)	OPERATING WEIGHT (POUNDS)
ESH-001	2"	1' - 2"	2"	0' - 8"	1"	0' - 11"	3' - 7"	1' - 3"	2' - 0"	2	2	5	360
ESH-002	2"	1' - 2"	2"	0' - 8"	1"	0' - 11"	3' - 7"	2' - 3"	2' - 0"	4	5	10	655
ESH-004	2"	1' - 7"	2"	1' - 1"	1"	1' - 4"	4' - 7"	2' - 3"	2' - 5"	4	18	10	955
ESH-008	2"	2' - 3"	2"	1' - 1"	1"	1' - 8"	4' - 9"	2' - 3"	3' - 5"	9	18	25	1,713
ESH-012	3"	2' - 3"	3"	1' - 1"	1"	1' - 8"	4' - 9"	3' - 3"	3' - 5"	14	28	38	2,492
ESH-016	3"	2' - 3"	3"	1' - 1"	1"	1' - 8"	4' - 9"	4' - 3"	3' - 5"	19	37	51	3,272
ESH-020	3"	2' - 3"	3"	1' - 1"	1"	1' - 8"	4' - 9"	5' - 3"	3' - 5"	24	46	64	4,060
ESH-024	3"	2' - 11"	3"	1' - 1"	1"	2' - 0"	4' - 11"	4' - 3"	4' - 5"	28	37	92	4,828
ESH-030	4"	2' - 11"	4"	1' - 1"	1"	2' - 0"	4' - 11"	5' - 3"	4' - 5"	36	46	115	5,976
ESH-036	4"	3' - 5"	4"	1' - 7"	1"	2' - 6"	5' - 11"	4' - 3"	4' - 11"	28	79	92	6,158

HydroFloTech
 1875 BIG TIMBER ROAD
 ELGIN, IL 60123
 (630) 762-0380
 www.hydroflotech.com

DRAWN T. SUMMERS	6/8/2020	ISSUED FOR INFORMATION ONLY	
CHECKED		TITLE	
QA		HydroFloTech, OIL WATER SEPARATOR, ECONOSEP, ESH-XXX, 304 STAINLESS STEEL	
MFG		SIZE D	REV 0
APPROVED		DWG NO ESH-TABULATED	SHEET 1 OF 1
		SCALE 1 / 12	